



PLOT DATE: 3/27/08

PLANS FOR THE CONSTRUCTION OF DURHAM-PENTZ ROAD & BUTTE CAMPUS DRIVE SIGNALIZATION FINAL EROSION CONTROL PLAN SHEET

APN 041-130-048
BUTTE JUNIOR COLLEGE DISTRICT
R11 BOX 133 A
DURHAM, CALIFORNIA 94598
1972 R 1730105

APN 041-130-044
BUTTE JUNIOR COLLEGE DISTRICT
R11 BOX 133 A
DURHAM, CALIFORNIA 94598
1969 R 1567688

SCALE:
HORIZ: 1" = 30'
VERT: N/A

LEGEND:
HYDROSEEDING APPLICATION AREAS.....
FIBER ROLLS (WATTLES).....

HYDROSEEDING QUANTITIES
NW QUADRANT.....6,590 SF
NE QUADRANT.....5,960 SF
SE QUADRANT.....2,185 SF
SW QUADRANT.....2,075 SF
TOTAL.....16,810 SF

APPROX. WATTLES QUANTITIES
NW QUADRANT.....200 LF
NE QUADRANT.....250 LF
SE QUADRANT.....80 LF
SW QUADRANT.....76 LF
TOTAL.....606 LF

NOTE:
SEE EROSION CONTROL IN PROJECT SPECIFICATIONS.
ALL AREAS THAT HAVE BEEN DISTURBED BY CONTRACTOR STAGING AND STORAGE AREA SHALL BE HYDRO-BEEDDED AT CONTRACTORS EXPENSE AFTER CLEANUP.

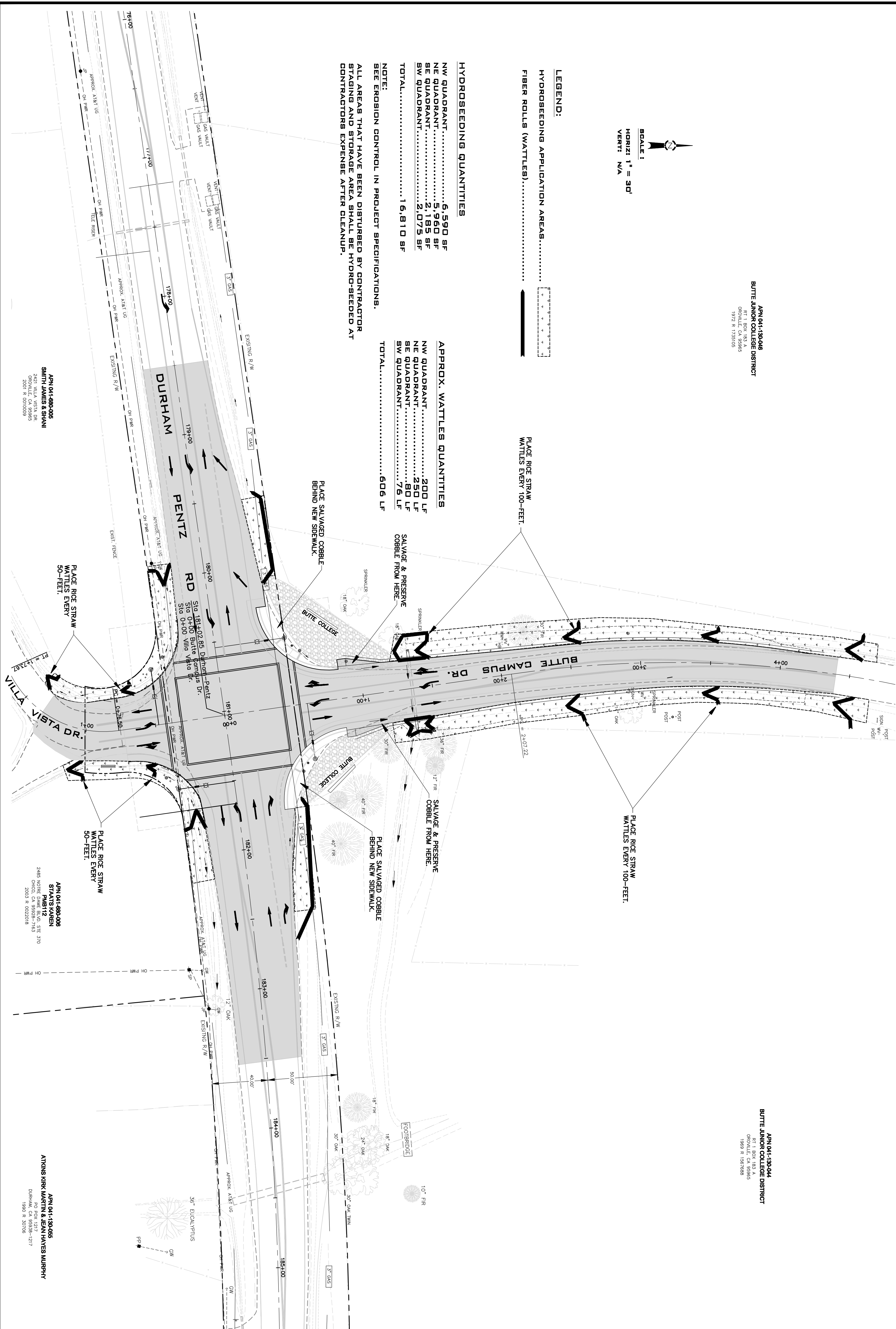

APN 041-680-005
SMITH JAMES & SHAW
2421 VILLA VISTA DR.
ORNDALE, CA 95955
2003 R 050589

APN 041-680-006
STRAVS KAREN
PHB112
2485 NORTON ST. STE 370
CHICO, CA 95926-7463
2003 R 0222018

APN 041-130-085
ATKINS MIK MARTIN & JEAN HAYES MURPHY
PO BOX 1217
DURHAM, CA 94598-1217
1969 R 30700

439417-06-1
9
FILE NO. E-2687