

PLOT DATE: 3/27/08

# PLANS FOR THE CONSTRUCTION OF DURHAM-PENTZ ROAD & BUTTE CAMPUS DRIVE SIGNALIZATION STRIPING & SIGNAGE PLAN SHEET

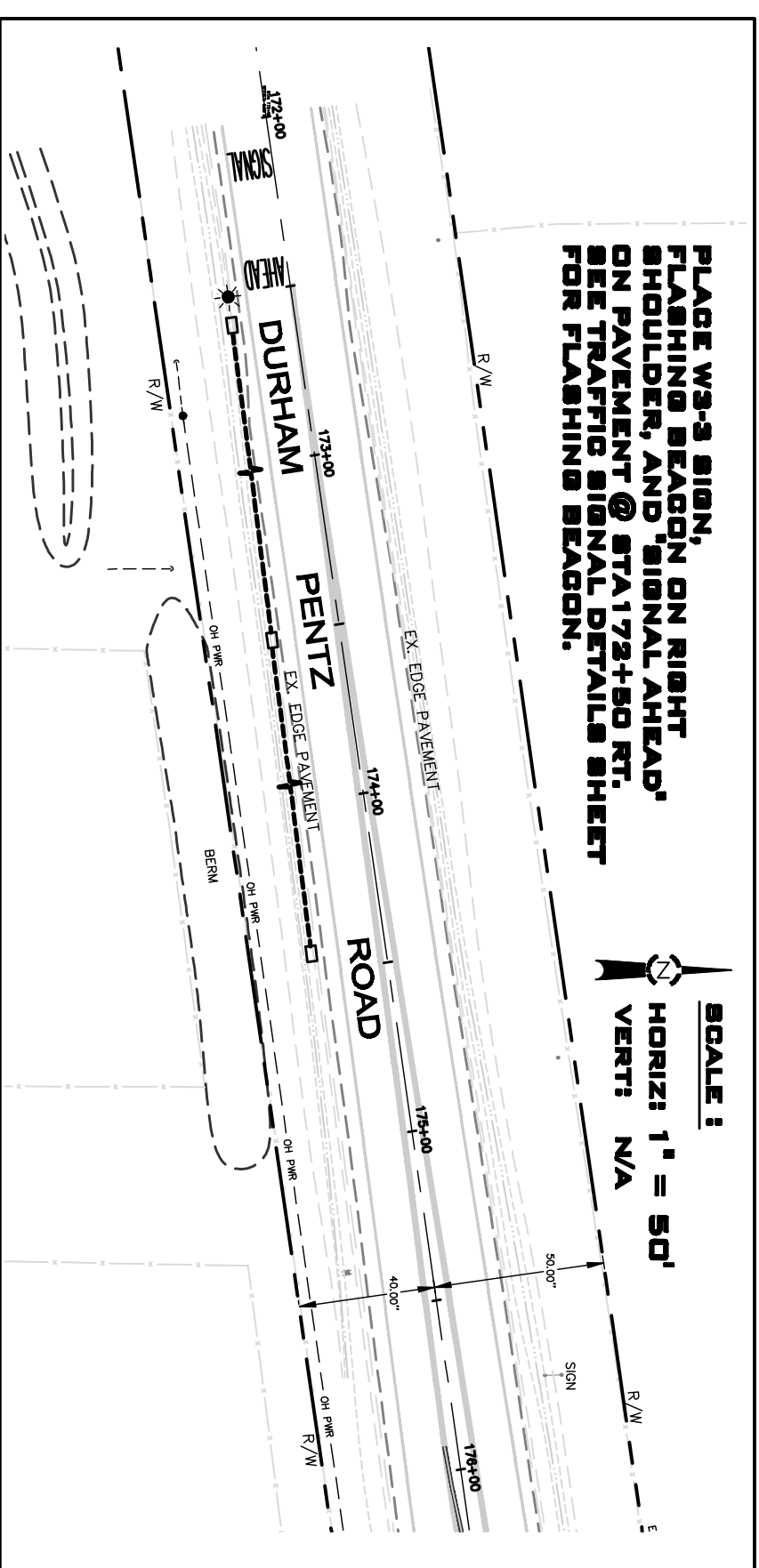
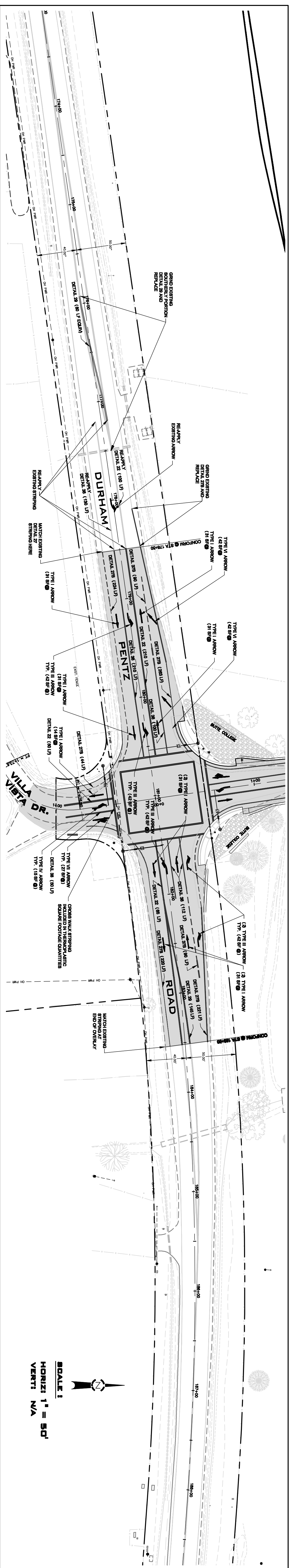

**THERMOPLASTIC AND RETROREFLECTIVE PAVEMENT MARKINGS**

ROAD NAME	TYPE 'D' REFLECTIONS	TYPE 'B' REFLECTIONS	THERMOPLASTIC STRIPE (YELLOW) (LF)	THERMOPLASTIC STRIPE (WHITE) (LF)	THERMOPLASTIC MARKING (WHITE) (SF)
DURHAM-PENTZ ROAD (WEST)	35	45	940	1,547	547
DURHAM-PENTZ ROAD (EAST)	20	18	710	845	486
VILLA VISTA DR (SOUTH)	7	7	100	188	188
BUTTE CAMPUS DR (NORTH)	32	11	1,200	1,004	238
<b>TOTALS</b>	<b>94</b>	<b>81</b>	<b>2,950</b>	<b>3,584</b>	<b>1,439</b>

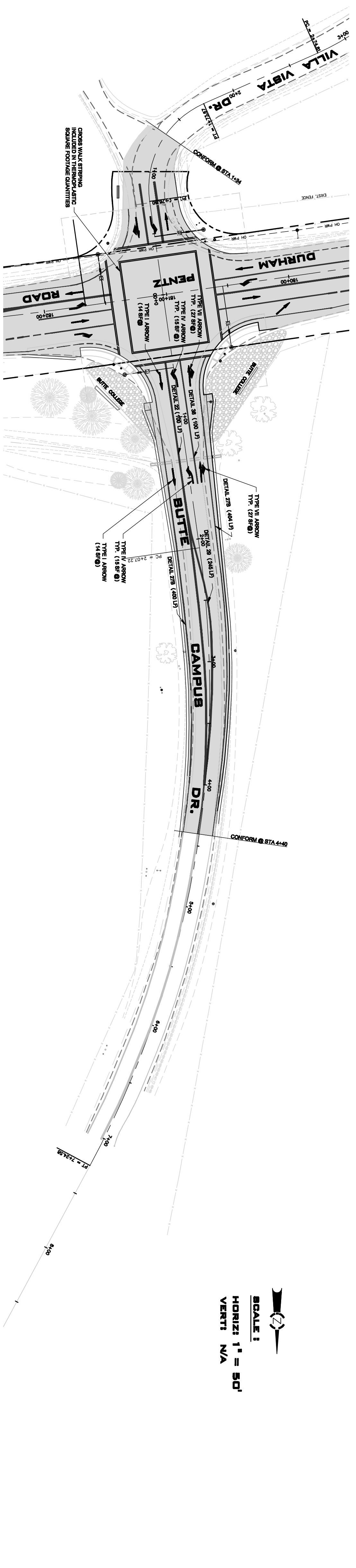
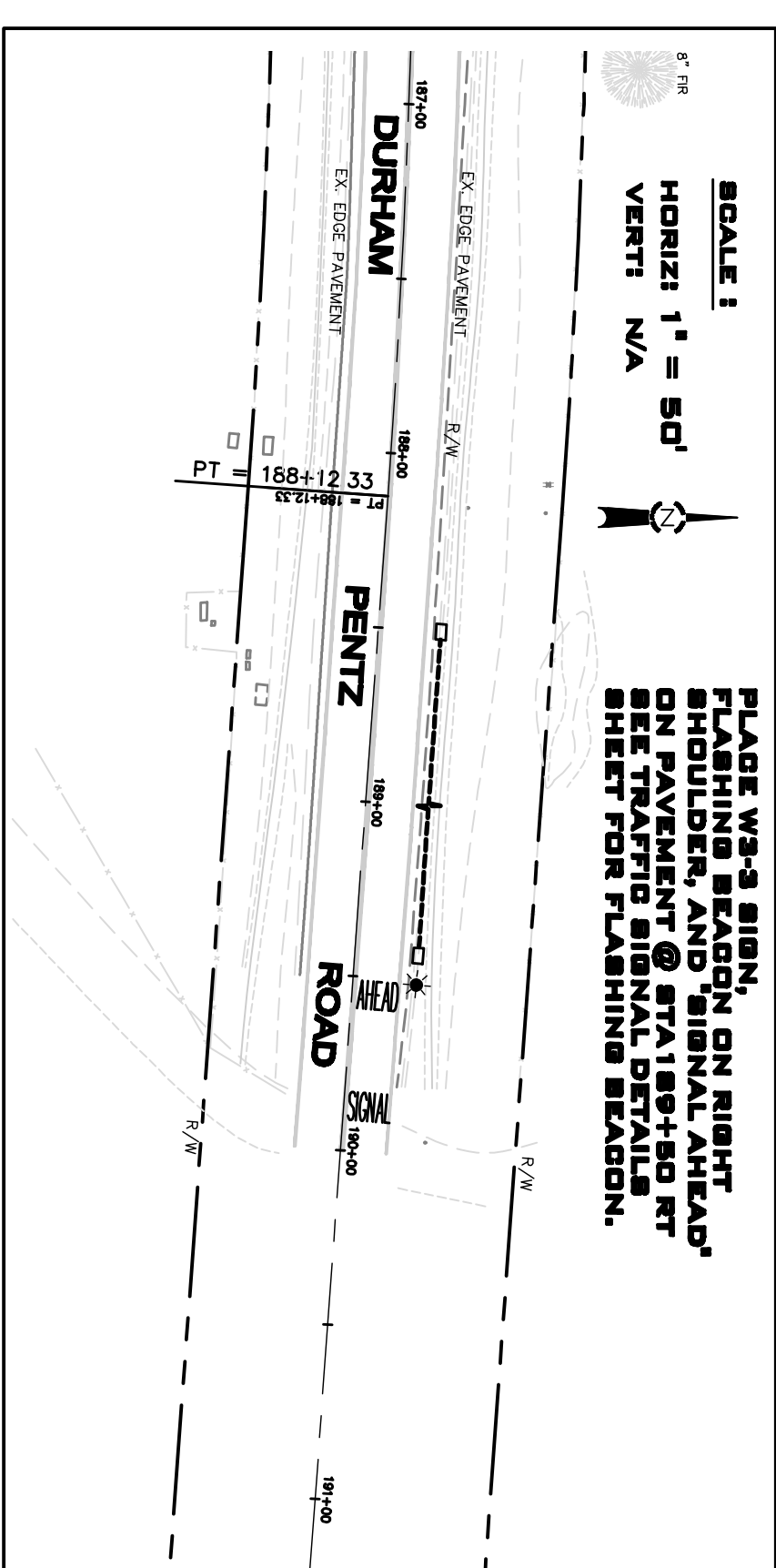

**'I' SIGNS**  
NEXT TO SCALE

DURHAM-PENTZ RD
VILLA VISTA DR
BUTTE CAMPUS DR.
VILLA VISTA DR.
BUTTE CAMPUS DR.

**INTERNALLY ILLUMINATED STREET NAME SIGNS TO BE PLACED ON MAST ARM PER STD PLAN ES-70**

**SIGNAGE SCHEDULE\***

QUANTITY	SIGN PANELS	POST SIZE	INSTALLATION LOCATION	SIGN MESSAGE
4	R3-4	--	MAST ARM INSTALLATION	NO U TURN
4	I' SIGNS	--	MAST ARM INSTALLATION	SEE INSET ON THIS SHEET
4	C-1B	4' X 4'	POST INSTALLATION	ROAD CONSTRUCTION AHEAD
4	C-13	4' X 4'	POST INSTALLATION	ROAD CONSTRUCTION AHEAD
2	W3-3	2' X 2'	TELESPAR OR BETTER	SIGNAL AHEAD
2	W3-3	-	ON FLASHING BEACONS	SIGNAL AHEAD

**FOR ROADWAY THERMOPLASTIC AND RETROREFLECTIVE MARKINGS, SEE QUANTITIES ESTIMATE THIS SHEET.**

**PLACE A-D-18 (ROAD CONSTRUCTION AHEAD) SIGN AND A-D-13 (END CONSTRUCTION) SIGN APPROX. 500' FROM THE PROJECT LIMITS OR AS DETERMINED BY THE ENGINEER. (SEE SHEETS 4-9 FOR PROJECT LIMITS)**

**REMOVE ALL EXISTING STRIPING BY SIGNING FOR THE FOLLOWING LIMITS**

DURHAM-PENTZ ROAD:  
STA 175+92 4.0' RT TO STA 177+50 6.0' LT  
STA 178+11 18.0' LT TO STA 178+50 21.0' LT