

NOTE:
EDGE OF PAYMENT (EP) ELEVATIONS
ARE PRIOR TO OVERLAY.

H SCALE: 1" = 10'
V SCALE: 1" = 10'

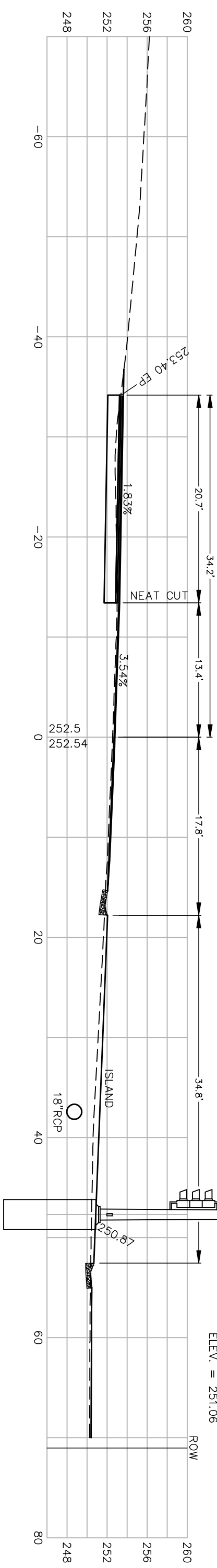
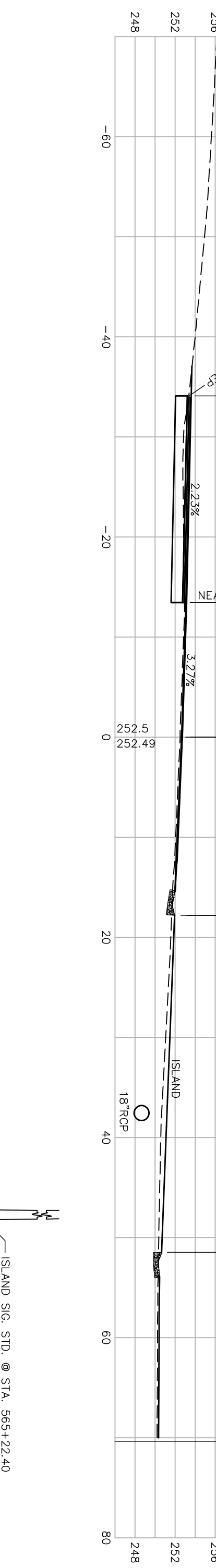
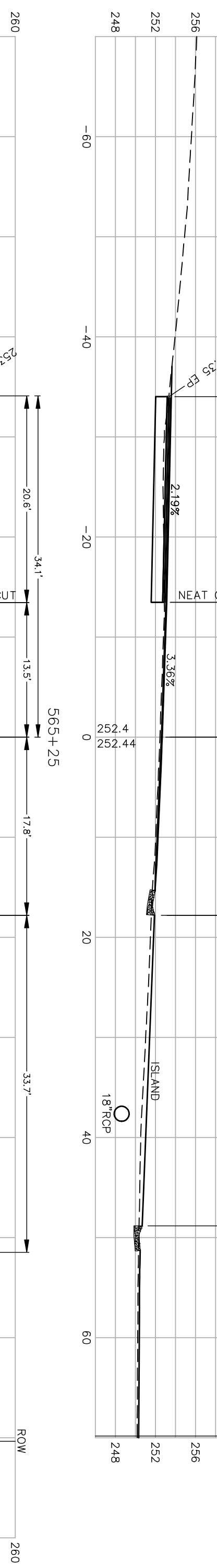
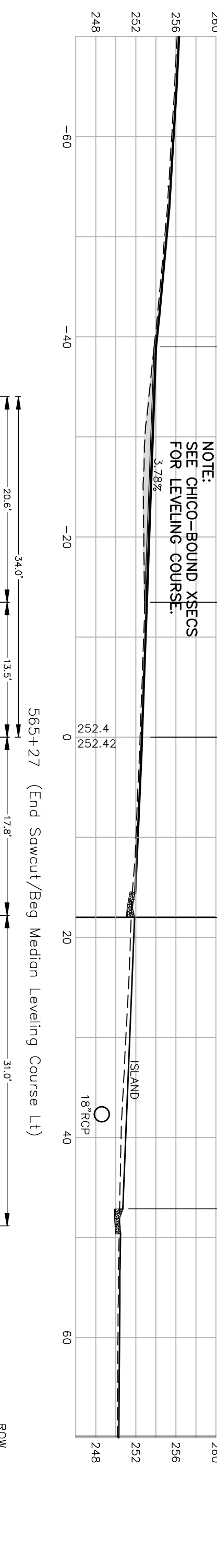
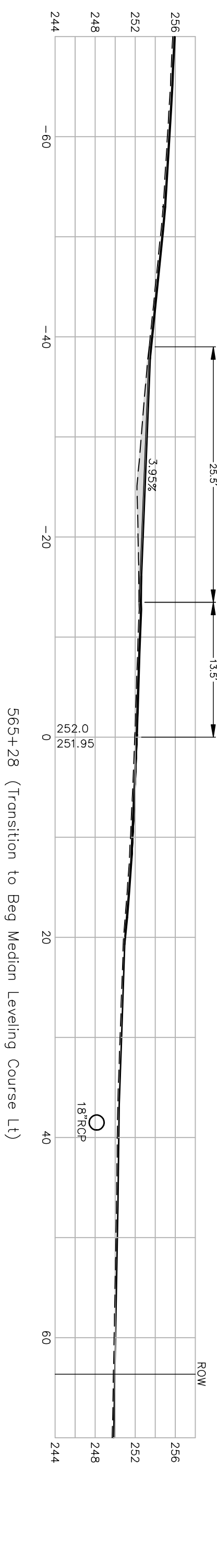
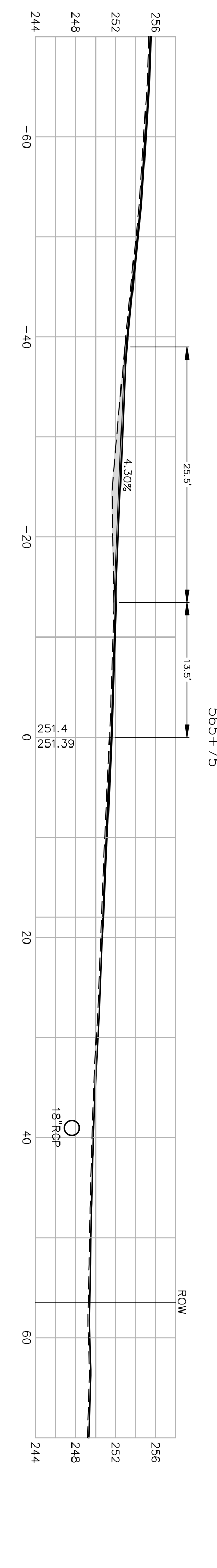
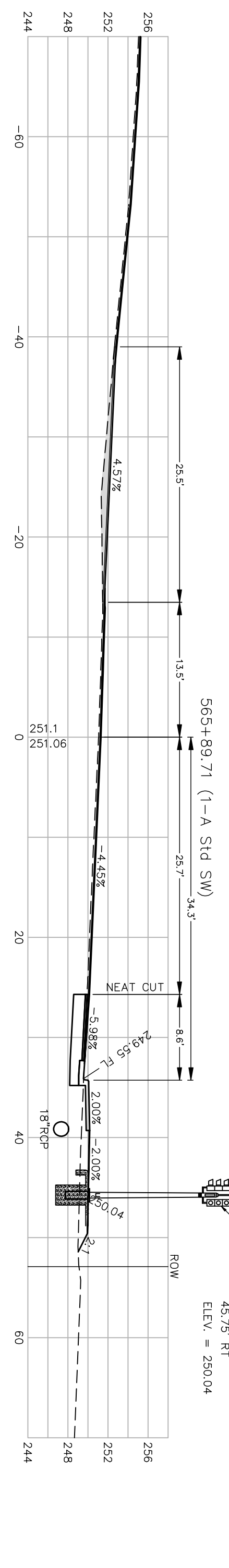
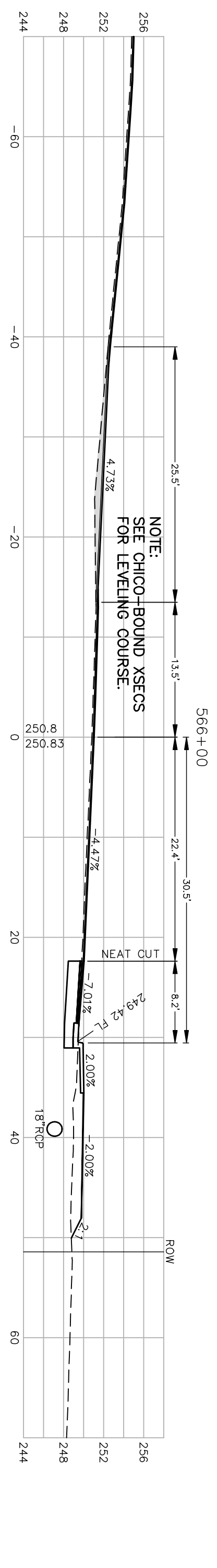

566+43 (End Overlay/Grinding)

566+40 (End Sawcut/ End Topper - Match Rt)

566+25

566+20.26 (Beg Topper/End Ramp Rt)

566+15 (Transition from End Return Rt)

566+14.14 (End Return Rt)

566+13.49 (Sig Sid SW)

NOTE:
EDGE OF PAYMENT (EP) ELEVATIONS
ARE PRIOR TO OVERLAY.

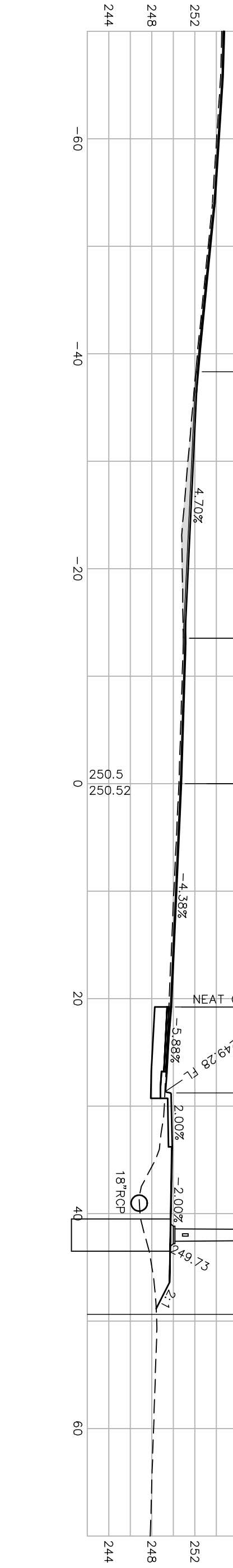
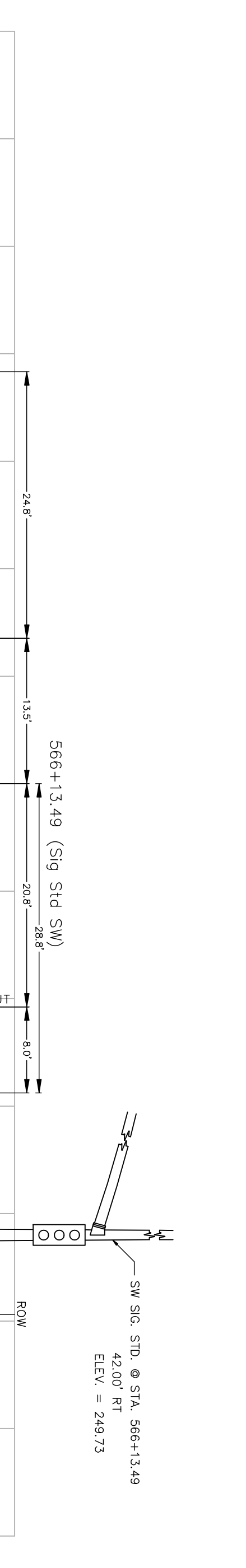
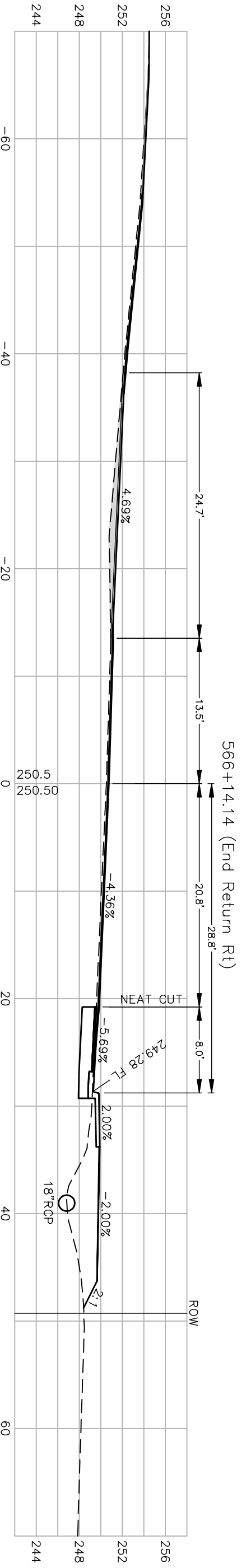
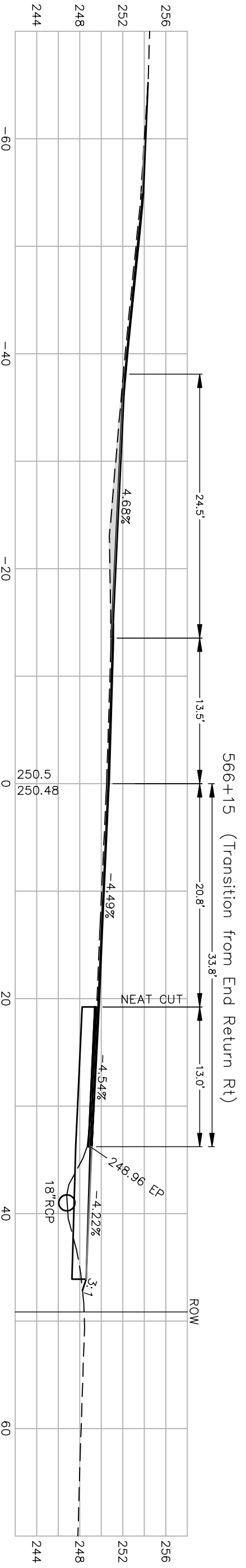
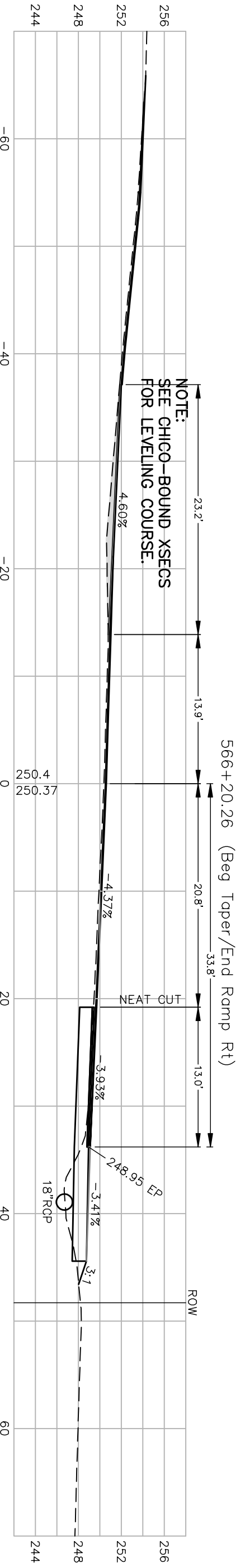
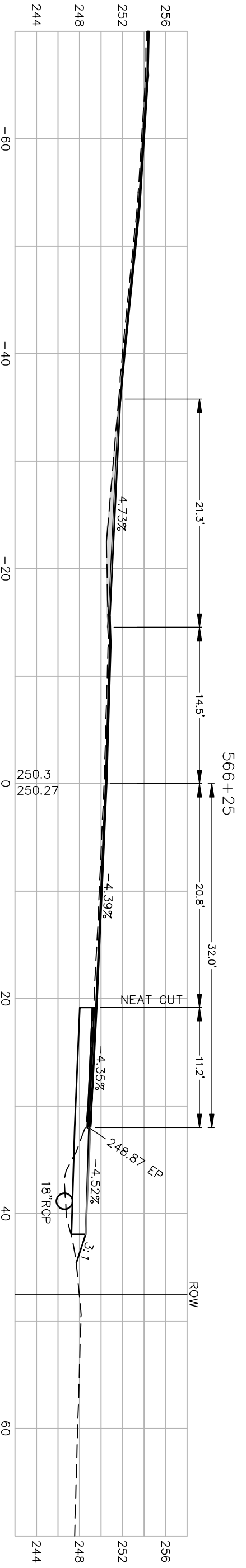
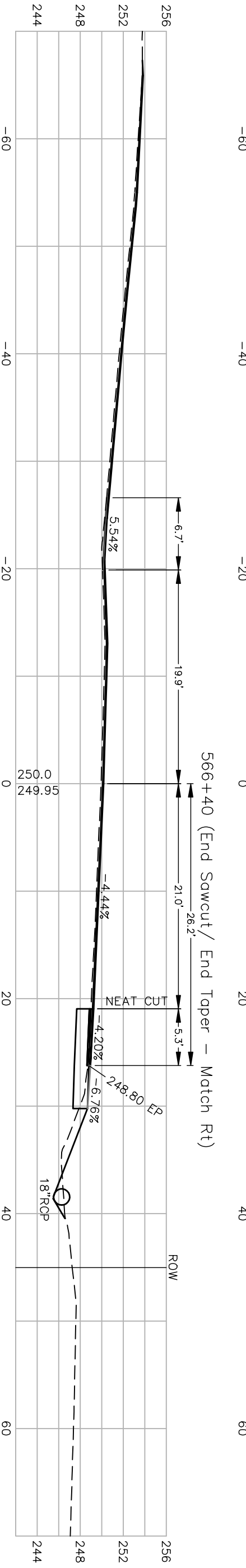
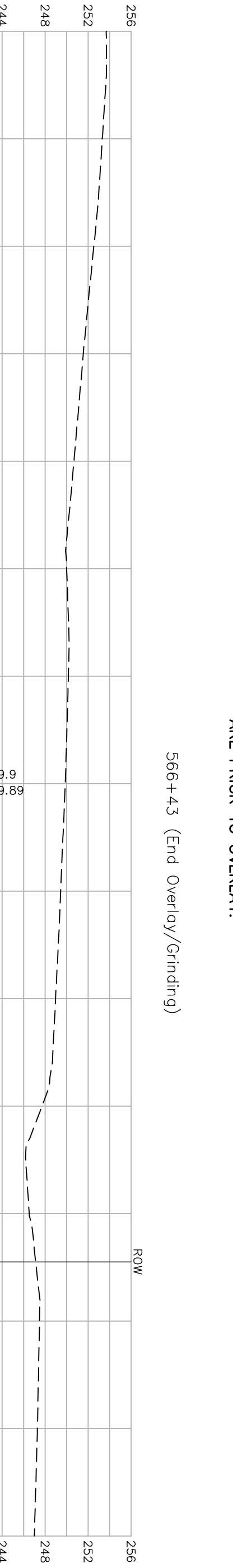

PLOT DATE: MAY 07, 2008

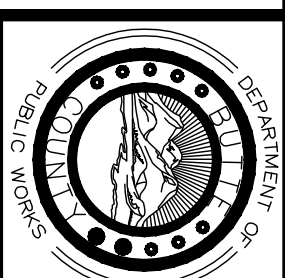

SKYWAY AT HONEY RUN ROAD TRAFFIC SIGNALIZATION

CROSS SECTIONS FOR SKYWAY (PARADISE-BOUND)

12112

51261-1-06-1

FILE NO. E-2686