

THERMOPLASTIC AND RETROREFLECTIVE PAVEMENT MARKINGS

ROAD NAME	TYPE 'A' NON-REFLECTIVE REFLECTORS	TYPE 'C' REFLECTORS	TYPE 'D' REFLECTORS	TYPE 'E' REFLECTORS	TYPE 'H' REFLECTORS	THERMOPLASTIC STRIPE (YELLOW) (LF)	THERMOPLASTIC STRIPE (WHITE) (LF)	THERMOPLASTIC MARKING (WHITE) (SF)
SKYWAY (CHICGO BOUND)	40	26	0	19	19	430	1,766	744
SKYWAY (PARADISE BOUND)	40	38	0	0	20	440	1,778	785
LONGEST DR	0	0	16	9	0	324	360	276
HONEY RUN ROAD	0	0	24	17	0	524	1,170	444
TOTALS	80	64	40	45	39	1,718	5,074	2,249

NOTE:
STRIPING QUANTITIES ARE MEASURED IN LENGTHS OF EQUIVALENT 4" WIDTH.
TYPE 'C' REFLECTORS SHALL BE UTILIZED IN PLACE OF TYPE 'E' REFLECTORS ON THE SKYWAY FOR DETAILS 13 & 38 ON ALL NEW STRIPING FOR DIRECTIONAL TRAFFIC LANES ENTERING THE INTERSECTION.

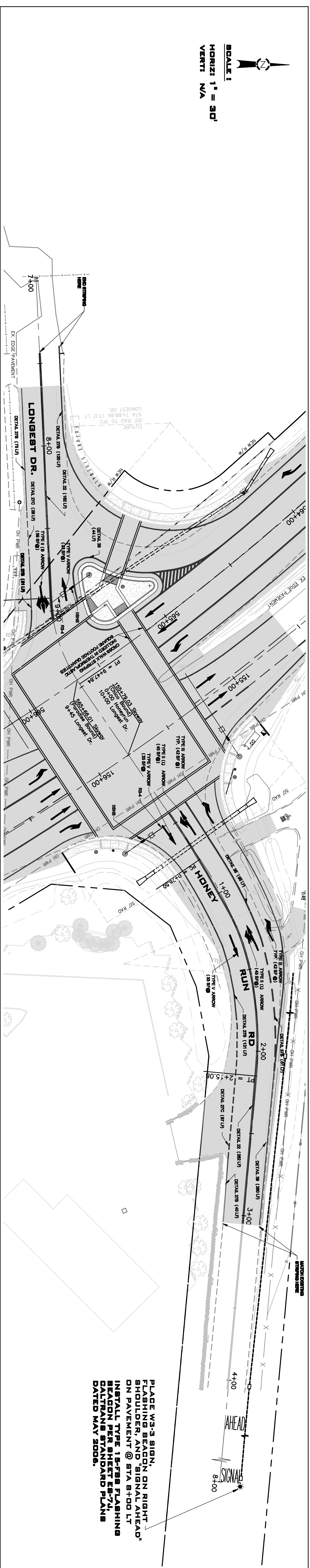
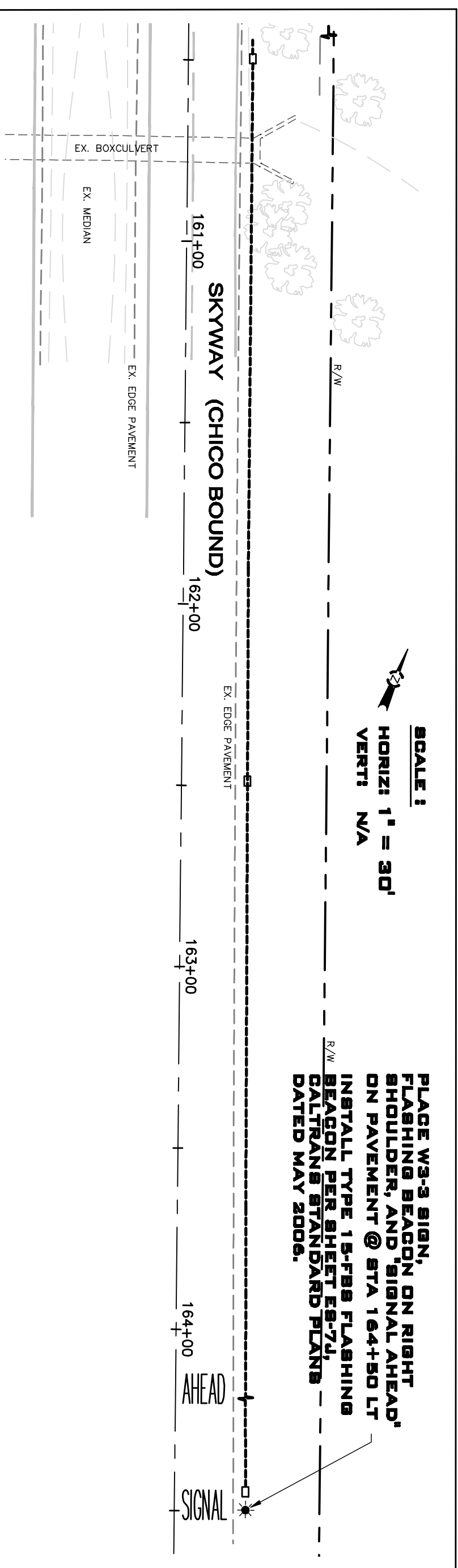

- '118N3' SIGNS**
NEXT TO SCALE
- SKYWAY
 - HONEY RUN RD
 - LONGEST DR
 - HONEY RUN RD
 - LONGEST DR

INTERNALLY ILLUMINATED STREET NAME SIGNS TO BE PLACED ON MAST ARM PER STD PLAN ES-70

SIGNAGE SCHEDULE

QUANTITY	SIGN PANELS	POST SIZE/TYPE	INSTALLATION LOCATION	SIGN MESSAGE
4	R3-4	--	MAST ARM INSTALLATION	NO U TURN
4	'118N3	--	MAST ARM INSTALLATION	SEE INSERT ON THIS SHEET
4	C-1-B	4" X 4" / WOOD	POST INSTALLATION	ROAD CONSTRUCTION AHEAD
4	C-1-3	4" X 4" / WOOD	POST INSTALLATION	END CONSTRUCTION
2	W3-3	2" X 2" / TELESPAR OR BETTER	POST INSTALLATION	SIGNAL AHEAD
2	W3-3	-	ON FLASHING BEACONS	SIGNAL AHEAD

FOR ROADWAY THERMOPLASTIC AND RETROREFLECTIVE MARKINGS SEE ESTIMATED QUANTITIES THIS SHEET.
PLACE A C-1-B (ROAD CONSTRUCTION AHEAD) SIGN AND A C-1-3 (END CONSTRUCTION) SIGN APPROX. 500' FROM THE PROJECT LIMITS OR AS DETERMINED BY THE ENGINEER. (SEE SHEETS 4-9 FOR PROJECT LIMITS)

**PLANS FOR THE CONSTRUCTION OF
SKYWAY AT HONEY RUN ROAD SIGNALIZATION
STRIPING & SIGNAGE PLAN SHEET**

PLOT DATE: MAY 10, 2008

