

**SKYWAY**

THERMOPLASTIC AND RETROREFLECTIVE PAVEMENT MARKINGS			
ROAD NAME	TYPE OF REFLECTORS	4" THERMOPLASTIC STRIPE (WHITE) (LF)	8" THERMOPLASTIC MARKING (WHITE) (SF)
BIKWAY (WEST)	SB	3,006	948
<b>TOTALS</b>	<b>SB</b>	<b>3,006</b>	<b>948</b>
			<b>399</b>

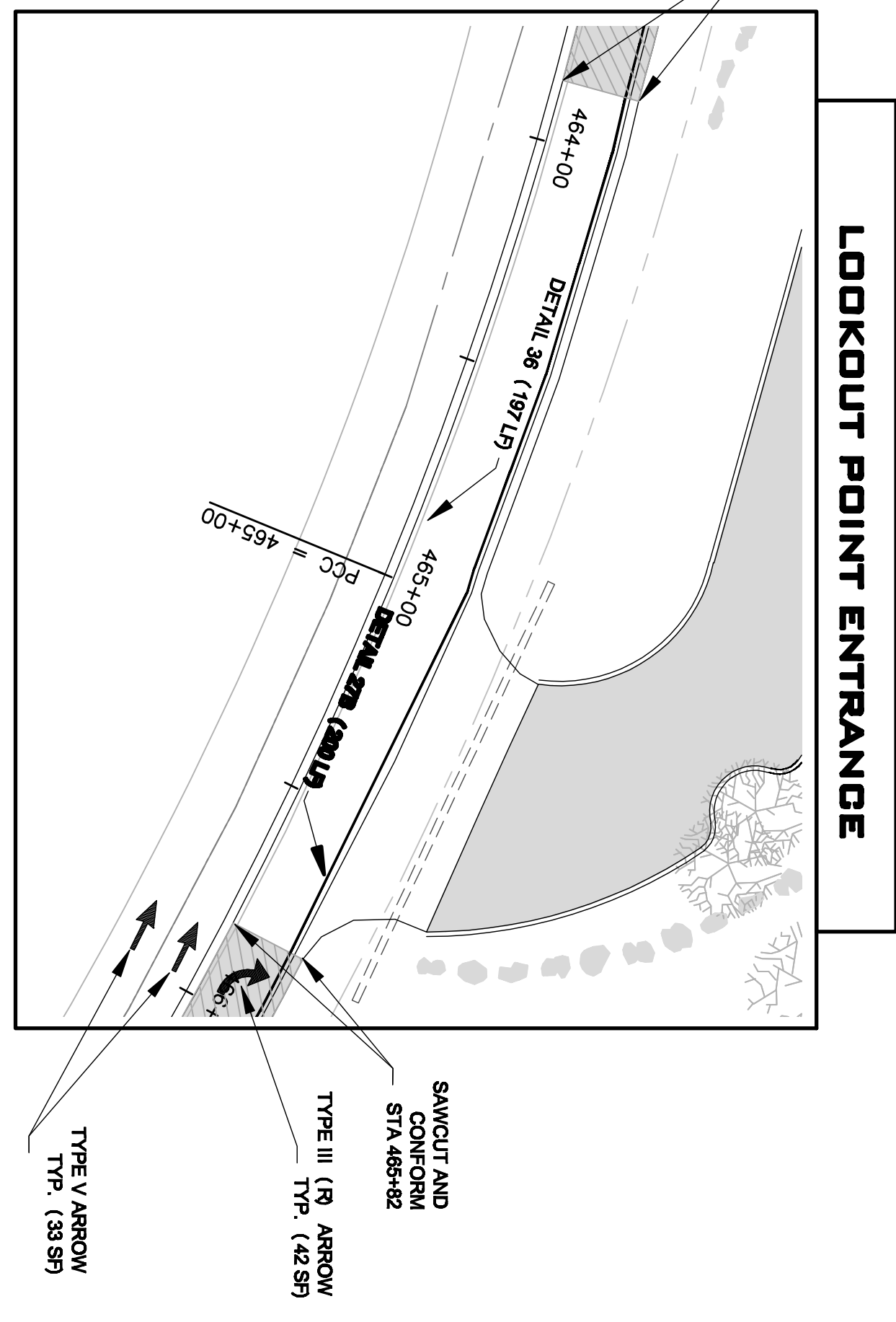

**LOOKOUT POINT ENTRANCE**

SIGNAGE SCHEDULE*			
QUANTITY	SIGN PANELS	POST SIZE	INSTALLATION LOCATION
2	R6-1 (RT)	-	BIKWAY MEDIUM APPROX FROM DRIVE
2	R3-SR	-	WEST SIDE OF ENTRANCES
1	W20-1	4' X 4'	POST INSTALLATION
1	020-2	4' X 4'	POST INSTALLATION
1	D7-1	-	1000' E/O ENTRANCE
1	G72(CA)	-	RIGHT TURN LANE SHLDR
1	R99	-	DIABLED PERSONS PARKING SIGNAGE
1	R99A	-	VAN ACCESSIBLE PARKING STALL

FOR ROADWAY THERMOPLASTIC AND RETROREFLECTIVE PAVEMENT MARKINGS, SEE QUANTITIES ESTIMATED ON THIS SHEET.  
 ALL SIGN POSTS SHALL BE TYPE TELESPAR OR EQUIVALENT

PLACE A W20-1 (ROAD WORK AHEAD) SIGN AND A 020-2 (END ROAD WORK) SIGN APPROX. 150' FROM THE PROJECT LIMITS OR AS DETERMINED BY THE ENGINEER. (SEE SHEETS 4-6 FOR PROJECT LIMITS)

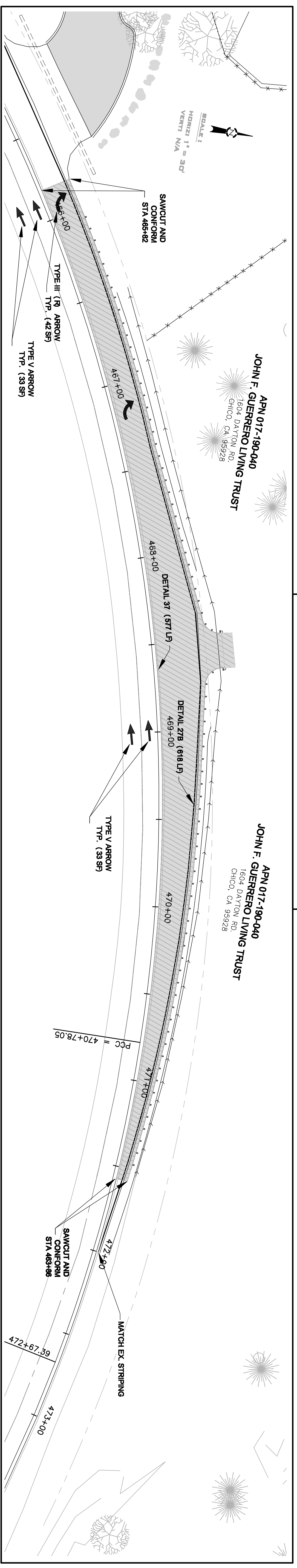

**SKYWAY**

**PLANS FOR THE CONSTRUCTION OF  
 SKYWAY LOOKOUT POINT PARKING & PEDESTRIAN VIEWING FACILITY  
 TRAFFIC STRIPING & SIGNAGE PLAN SHEET**