

# COUNTY OF BUTTE DEPARTMENT OF PUBLIC WORKS

## PLANS FOR THE CONSTRUCTION OF SKYWAY LOOKOUT POINT PARKING AND PEDESTRIAN VIEWING FACILITY COUNTY PROJECT NO. 51261-2-2005-1

TO BE SUPPLEMENTED BY STATE OF CALIFORNIA DEPARTMENT OF TRANSPORTATION STANDARD PLANS - MAY 2006

APPROVED April 8, 2008

Mike Crump  
MIKE CRUMP, DIRECTOR OF PUBLIC WORKS  
R.C.E. C41977, LIC. EXP. MARCH 31, 2010

CHIEF BOARD OF SUPERVISORS

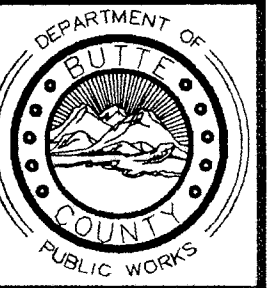

### SYMBOL LEGEND

DESCRIPTION	EXISTING	PROPOSED
BRASS CAP OR BRASS CAP WELL	B.C. #	
CENTERLINE OF CONSTRUCTION		10+00
CORRUGATED METAL PIPE(CMP)	-----	=====
EDGE OF PAVEMENT	-----	-----
FENCE		XXXXXXXXXX
FLOWLINE	-----	-----
METAL BEAM GUARD RAIL	[Symbol]	[Symbol]
OPENGRADE	-----	-----
PAVING		[Symbol]
RIGHT-OF-WAY	-----	-----
ROCK PILES		[Symbol]
SHRUBS	○ ○ ○ ○	
TREES	[Symbol] [Symbol] [Symbol]	

### ABBREVIATIONS

AC	ASPHALT CONCRETE	INV	INVERT
B.C.	BRASS CAP	IP	IRON PIPE
BEG	BEGIN	LF	LINEAL FEET
CL	CENTERLINE	LT	LEFT
CMP	CORRUGATED METAL PIPE	MBGR	METAL BEAM GUARD RAIL
CONC.	CONCRETE	MPOC	MID POINT ON CURVE
CONST.	CONSTRUCT	PRC	POINT OF REVERSE CURVATURE
CSPA	CORRUGATED STEEL PIPE ARCH	PVI	POINT OF VERTICAL INTERSECTION
CTR	CENTER	RAD	RADIUS
D/W	DRIVEWAY	RET	RETURN
ELEV, EL	ELEVATION	RT	RIGHT
EP	EDGE OF PAVEMENT	R/W	RIGHT-OF-WAY
EX.	EXISTING	STA	STATION
FL	FLOWLINE	S	SLOPE
FT	FEET	W/	WITH
H	HORIZONTAL	V	VERTICAL

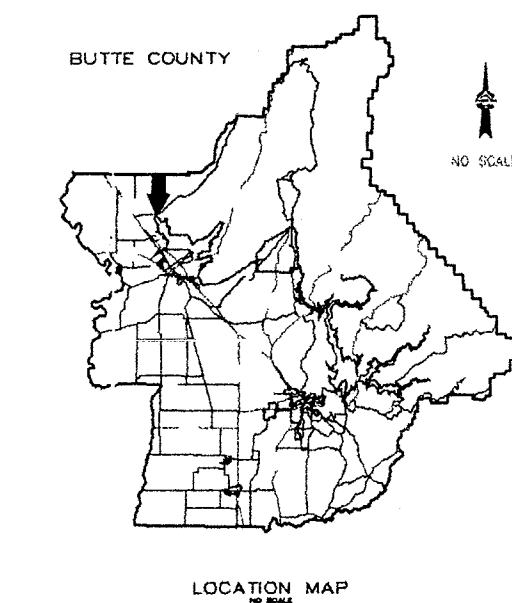
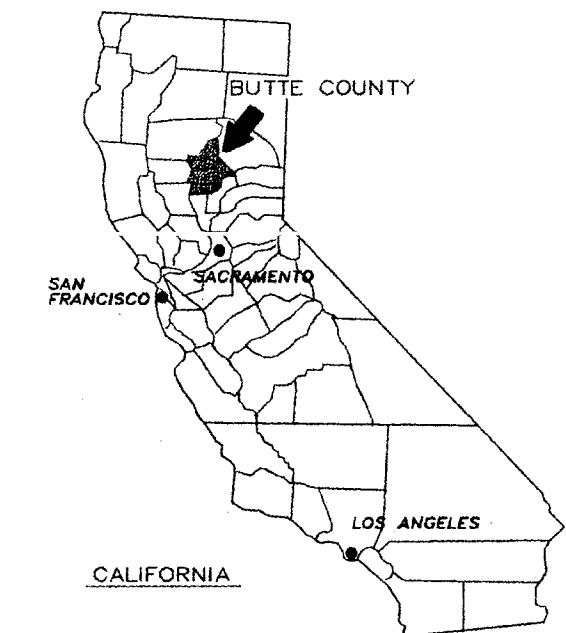
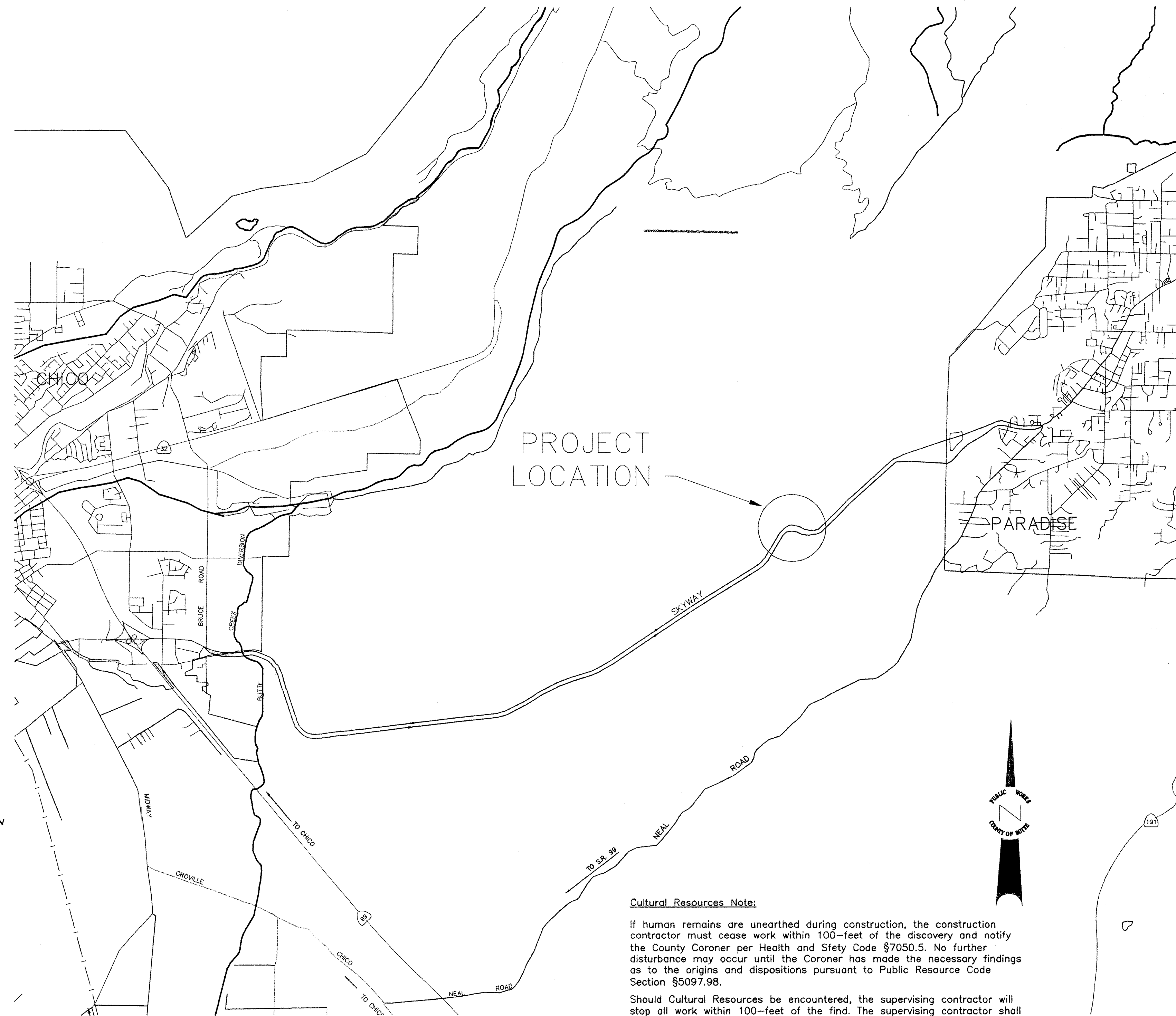

NOTES:  
THE EXISTENCE AND LOCATION OF ALL UTILITIES SHALL BE VERIFIED BY THE CONTRACTOR.

THE CONTRACTOR SHALL POSSESS A CLASS "A" LICENSE OR A COMBINATION OF CLASSES REQUIRED BY THE CATEGORIES AND TYPE OF WORK INCLUDED IN THIS CONTRACT AT THE TIME THIS CONTRACT IS AWARDED.

### INDEX OF SHEETS

SHEET NO.	TITLE
1 OF 9	TITLE SHEET
2 OF 9	MISCELLANEOUS DETAIL SHEET
3 OF 9	MISCELLANEOUS DETAIL SHEET
4 OF 9	PLAN & PROFILE SHEET
5 OF 9	PLAN & PROFILE SHEET
6 OF 9	PLAN & PROFILE SHEET
7 OF 9	GRADING & DRAINAGE PLAN SHEET
8 OF 9	TRAFFIC STRIPING & SIGNAGE PLAN SHEET
9 OF 9	FINAL EROSION CONTROL PLAN SHEET

### Cultural Resources Note:

If human remains are unearthed during construction, the construction contractor must cease work within 100-feet of the discovery and notify the County Coroner per Health and Safety Code §7050.5. No further disturbance may occur until the Coroner has made the necessary findings as to the origins and dispositions pursuant to Public Resource Code Section §5097.98.

Should Cultural Resources be encountered, the supervising contractor will stop all work within 100-feet of the find. The supervising contractor shall be responsible for reporting any such findings to the Public Works Department, and a qualified archeologist will be contacted to conduct meetings with on-site employees, determine appropriate mitigation measures, and monitor the referenced mitigation measures.

PLANS FOR THE CONSTRUCTION OF  
SKYWAY LOOKOUT POINT PARKING & PEDESTRIAN VIEWING FACILITY  
TITLE SHEET

PROJECT NUMBER  
51261-2-2005-1

1  
9

FILE NO. E-2701