

COUNTY OF BUTTE

DEPARTMENT OF PUBLIC WORKS

PLANS FOR THE CONSTRUCTION OF S.R. 99 FRONTAGE ROAD FROM ENTLER AVENUE TO COMANCHE CREEK

COUNTY PROJECT NO. 50255C-05-1
PROJECT LENGTH: APPROXIMATELY 0.34 MI.

APPROVED: *Steve Z...* 2009
 MIKE CRUMP, DIRECTOR OF PUBLIC WORKS
 R.C.E. C41977, L.I.C. EXP. MARCH 31, 2010
Bill Connolly
 CHAIR, BOARD OF SUPERVISORS

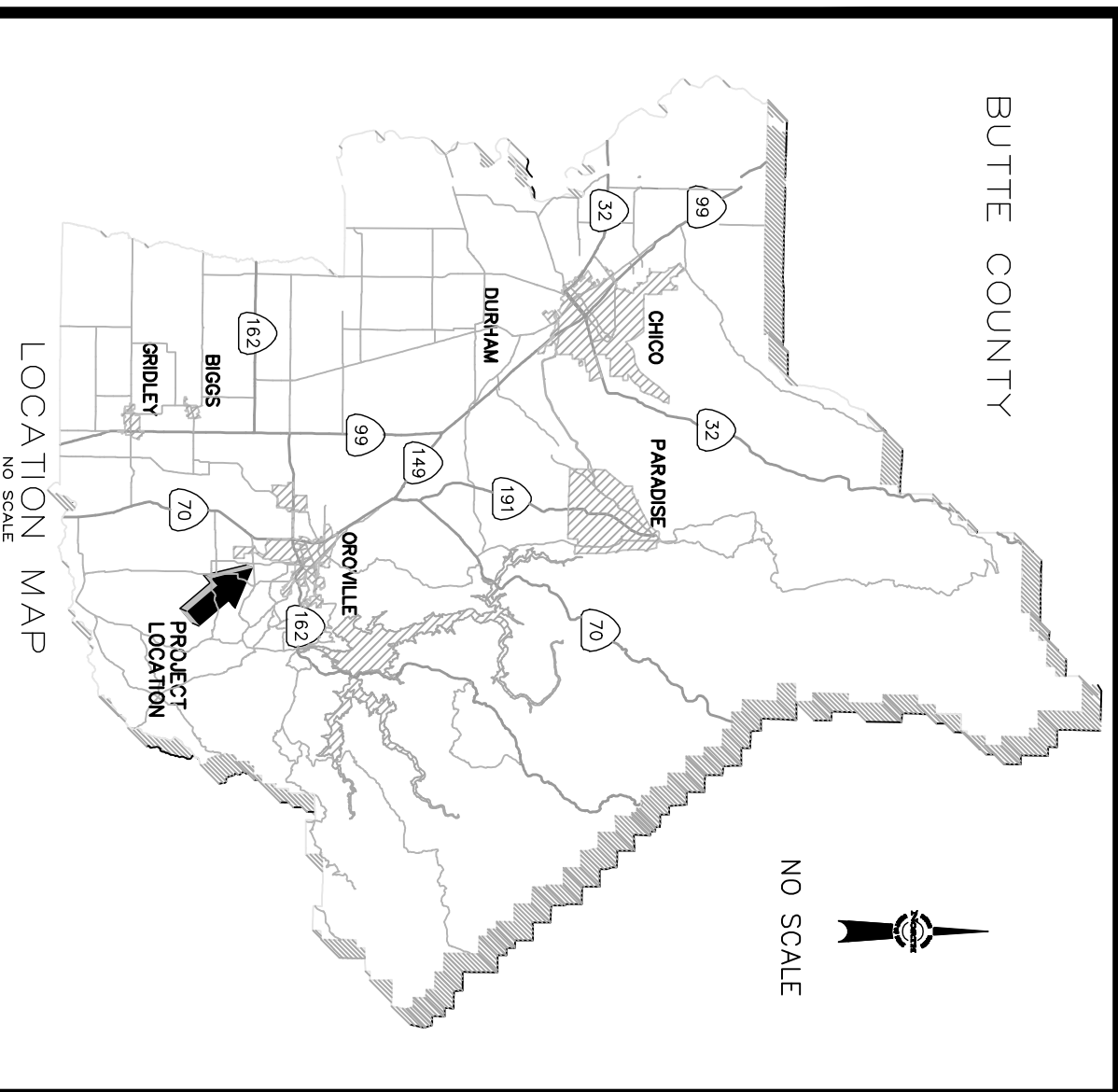

TO BE SUPPLEMENTED BY THE "STATE OF CALIFORNIA, DEPARTMENT OF TRANSPORTATION STANDARD PLANS, DATED MAY 2006", AND ALL AMENDMENTS APPROXIMATE EARTHWORK 4,715 CY

NOTE:
 THE EXISTENCE AND LOCATION OF UTILITIES SHALL BE VERIFIED BY THE CONTRACTOR.
 CALL USA NORTH 2 DAYS IN ADVANCE OF ALL EXCAVATION: 800-227-2800

THE CONTRACTOR SHALL POSSESS A CLASS "A" LICENSE OR A COMBINATION OF CLASSES REQUIRED BY THE CATEGORIES AND TYPE OF WORK INCLUDED IN THIS CONTRACT AT THE TIME THIS CONTRACT IS AWARDED.

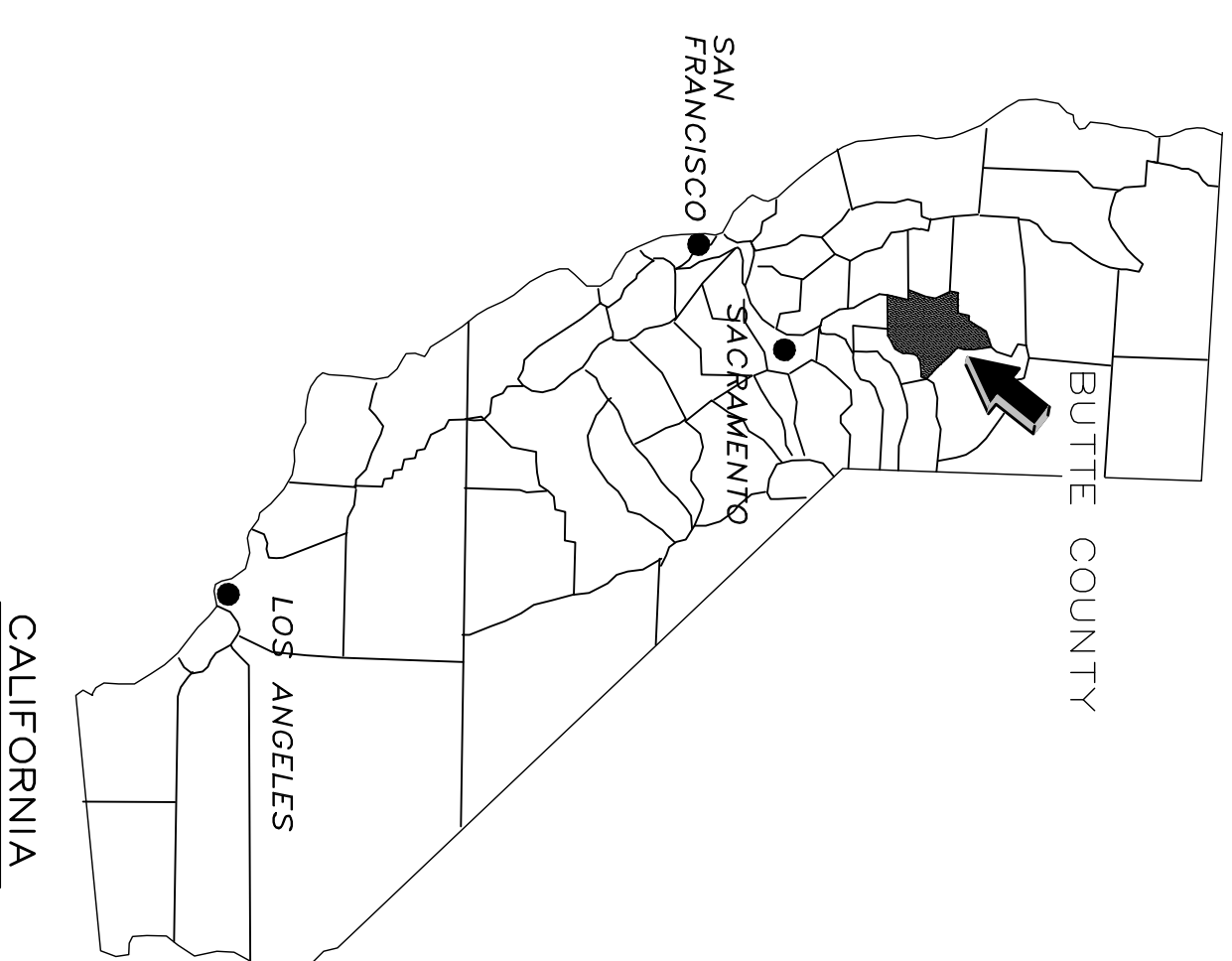

Cultural Resources Note:
 If human remains are unearthed during construction, the construction contractor must cease work within 100-feet of the discovery and notify the County Coroner per Health and Safety Code §7050.5. No further disturbance may occur until the Coroner has made the necessary findings as to the origins and dispositions pursuant to Public Resource Code Section §5097.98.

Should Cultural Resources be encountered, the supervising contractor will be responsible for reporting any such findings to the Public Works Department, and a qualified archeologist will be contacted to conduct meetings with on-site employee, determine appropriate mitigation measures, and monitor the referenced mitigation measures.

INDEX OF SHEETS

SHEET NO.	TITLE SHEET
1 OF 11	TITLE SHEET
2 OF 11	DETAIL SHEET
3 OF 11	DETAIL SHEET
4 OF 11	DETAIL SHEET
5 OF 11	PLAN & PROFILE SHEET - FRONTAGE RD
6 OF 11	PLAN & PROFILE SHEET - FRONTAGE RD
7 OF 11	PLAN & PROFILE SHEET - FRONTAGE RD
8 OF 11	PLAN & PROFILE SHEET - ENTLER AVE
9 OF 11	GRADING/DEMOLITION SHEET
10 OF 11	STRIPING & SIGNAGE SHEET
11 OF 11	FINAL EROSION CONTROL SHEET

APPLICABLE STANDARD PLAN SHEETS

A82A	EXCAVATION AND BACKFILL MISC. DETAILS
A82F	EXCAVATION AND BACKFILL METAL AND PLASTIC CULVERTS
A87	CURBS, DIKES, AND DRIVEWAYS
A88A	CURB RAMP DETAILS
D94A	METAL AND PLASTIC FLARED END SECTIONS

CONTACTS

BUTTE COUNTY PUBLIC WORKS:
 CONSTRUCTION.....SCOTT HIGHTOWER (530) 538-7681 ext 2027
 ENGINEERING.....MONTY HANSEN (530) 538-7681 ext 2017

UTILITIES:

PG&E GAS.....LARRY JACKSON, CHICO (530) 894-4773
 PG&E POWER.....LARD OELRICHS, CHICO (530) 896-4258
 AT&T.....BRUCE MCPHEE, REDDING (530) 229-2024
 COMCAST CABLE.....BRANDON STOKES, CHICO (530) 624-2896

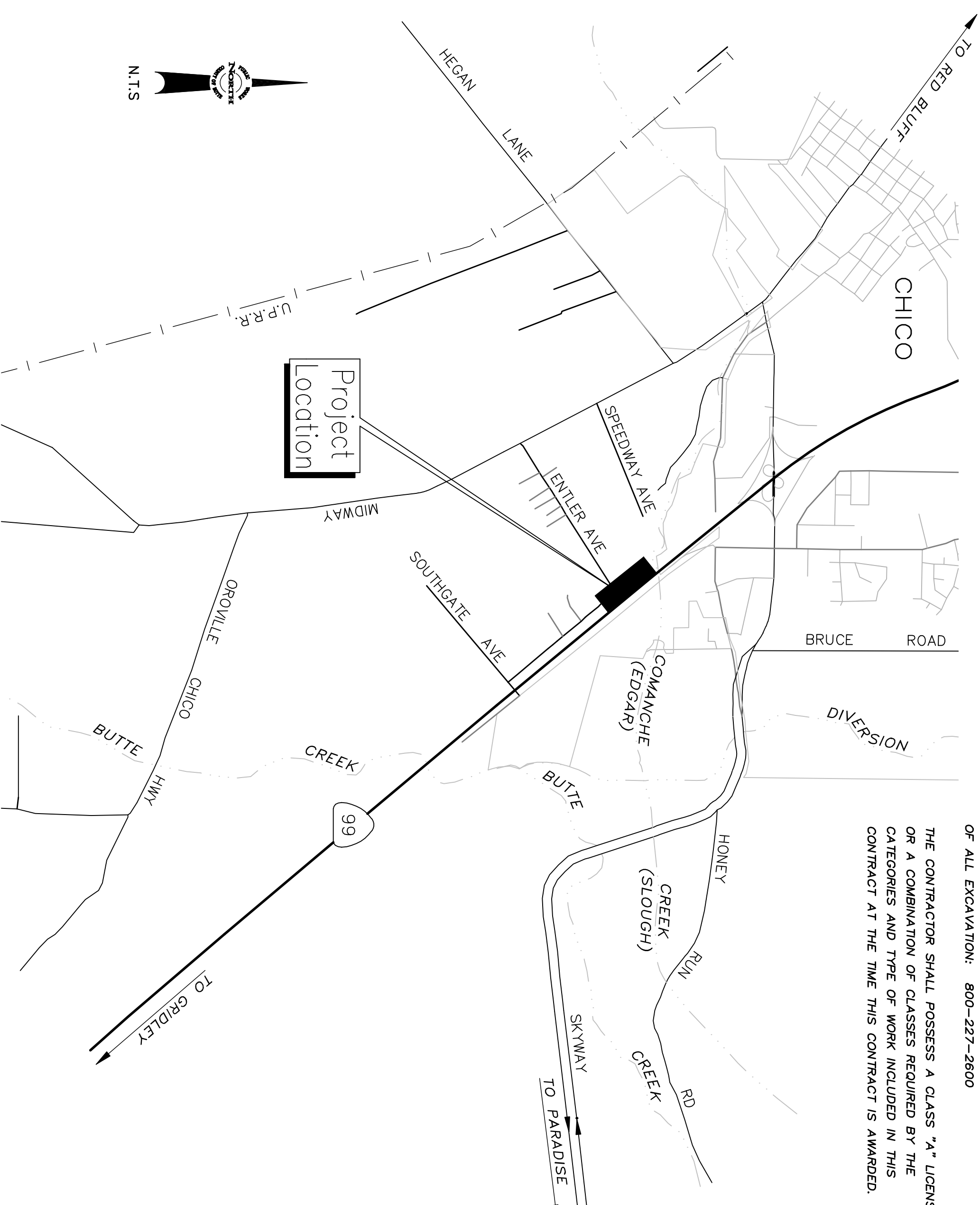

ABBREVIATIONS	EXISTING	PROPOSED
A/C ASPHALT CONCRETE		
AV. AVENUE		
B.C. BRASS CAP		
BEG. BEGIN		
CB. CATCH BASIN		
C.C./S./W. CURB, GUTTER, & SIDEWALK		
CL. CENTERLINE		
CMF. CORRUGATED METAL PIPE		
CONC. CONCRETE		
CONSTR. CONSTRUCT		
CSP. CORRUGATED STEEL PIPE		
CSA. CORRUGATED STEEL PIPE ARCH		
CTR. CENTER		
D/M. DRIVEWAY		
ELEC. ELECTRIC		
ELEV. EL. ELEVATION		
EP. EDGE OF PAVEMENT		
EX. EXISTING		
F.H. FIRE HYDRANT		
FL. FLOWLINE		
FT. FEET		
G. GAS		
G/W. GUY WIRE/ANCHOR		
H. HIGH DENSITY POLYETHYLENE		
HWP. HIGHWAY		
INV. INVERT		
IP. IRON PIPE		
LF. LINEAL FEET		
LN. LANE		
LT. LEFT		
MB. MALIBOX		
M/POC. MID POINT ON CURVE		
PERF. PERFORATED		
PAC. BELT. POINT OF VERTICAL INTERSECTION		
PVC. POLYVINYL CHLORIDE		
RAD. RADIUS		
R.E.C. RIGHT TO ENTER & CONSTRUCT		
RCP. REINFORCED CONCRETE ARCH PIPE		
RET. RETURN		
RT. RIGHT		
R/W. RIGHT-OF-WAY		
S. STATION		
ST. SLOPE		
ST. STREET		
SV. SERVICE		
SV. SIDEWALK		
S/W. TOP BACK OF CURB		
TBC. TELEPHONE		
TEL. TEMPORARY CONSTRUCTION EASEMENT		
T.C.E. TOP FACE OF CURB		
TG. TOP GRADE		
U/G. UNDERGROUND		
W. WATER		
W/. WATER METER		
WM. WATER VALVE		
WV. VERTICAL		
	SHRUBS	
	STREET LIGHT	
	TREES	
	UTILITY POLES	

UNIT JOINT POWER TELE SERVICE

